

Pinnacle Series

CLAD RADIUS

MEASUREMENT CONVERSIONS

STANDARD BRICKMOULD - DIRECT GLAZE													
Size Referenced	Daylite Opening		Glass Size		Frame Size		Rough Opening		Unit Size		Masonry Opening		
Daylite Opening	Dimension Needed												
			Width	+1	Width	+3	Width	+3 3/4	Width	+3	Width	+3 1/2	
				Height	+1	Height	+3	Height	+3 1/2	Height	+3	Height	+3 1/2
Glass Size	Width	-1			Width	+2	Width	+2 3/4	Width	+2	Width	+2 1/2	
	Height	-1			Height	+2	Height	+2 1/2	Height	+2	Height	+2 1/2	
Frame Size	Dimension Given	Width	-3	Width	-2			Width	+3/4	Width	+0	Width	+1/2
		Height	-3	Height	-2			Height	+1/2	Height	+0	Height	+1/2
Rough Opening	Dimension Given	Width	-3 3/4	Width	-2 3/4	Width	-3/4			Width	+3/4	Width	+1 1/4
		Height	-3 1/2	Height	-2 1/2	Height	-1/2			Height	+1/2	Height	+1
Unit Size	Dimension Given	Width	-3	Width	-2	Width	-0	Width	-3/4			Width	+1/2
		Height	-3	Height	-2	Height	-0	Height	-1/2			Height	+1/2
Masonry Opening	Dimension Given	Width	-3 1/2	Width	-2 1/2	Width	+1/2	Width	-1 1/4	Width	-1/2		
		Height	-3 1/2	Height	-2 1/2	Height	+1/2	Height	-1	Height	-1/2		

FRAME TO UNIT ADDERS

WM180 Brickmould	3/8" Subsill	+ 2 13/16	Width
		+ 1 3/4	Height
	1 1/4" Subsill	+ 2 13/16	Width
		+ 2 11/16	Height
	2 1/4" Subsill	+ 2 13/16	Width
		+ 3 11/16	Height
Williamsburg Casing	3/8" Subsill	+ 6 1/2	Width
		+ 3 5/8	Height
	1 1/4" Subsill	+ 6 1/2	Width
		+ 4 1/2	Height
	2 1/4" Subsill	+ 6 1/2	Width
		+ 5 1/2	Height
3 1/2" Flat Casing	3/8" Subsill	+ 5 7/8	Width
		+ 3 5/16	Height
	1 1/4" Subsill	+ 5 7/8	Width
		+ 4 3/16	Height
	2 1/4" Subsill	+ 5 7/8	Width
		+ 5 3/16	Height

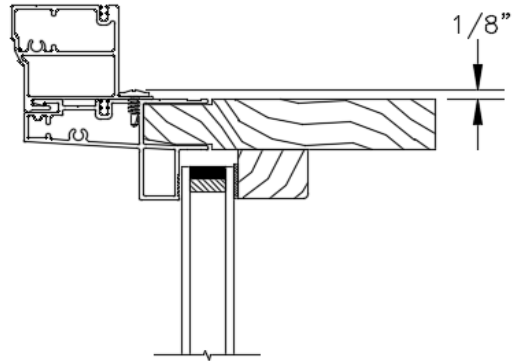

NOTE: RIGID NAIL FIN AND ALL CASING OPTIONS ARE APPLIED WITH SCREWS THAT SLIGHTLY PROTRUDE IN TO ROUGH OPENING BY $\frac{1}{8}$ ". THESE SCREWS ARE NOT INCLUDED IN ROUGH OPENING CALCULATIONS.

NOTE: ADD $\frac{3}{4}$ " TO UNIT WIDTH AND $\frac{1}{2}$ " TO UNIT HEIGHT TO CALCULATE MASONRY OPENING.