

Installation Guidelines



FOR PINNACLE SELECT MULTI-SLIDE PATIO DOORS

Installer

- Read instructions completely before attempting installation. Failure to follow these guidelines will forfeit all warranties (written or implied). Windsor Windows & Doors will not be held responsible for any claims or damages resulting from installation.
- Always provide a copy of these instructions to the homeowner.
- Contact your architect or construction professional for installation into other building designs or construction methods.
- Structural support of the sill is required to support the entire sill width, and depth of the sill's interior edge, to the exterior nose of the sill extrusion. If the architect's details do not include this type of structural support, a structural support must be installed and flashed.
- Regional codes and environmental conditions may require installation that is different from these guidelines. It is your responsibility to ensure that local codes and ordinances are followed.

Warning

- ⚠ **Work Safe!** Always wear proper eye and hearing protection when installing or adjusting Windsor products. **Use Power Tools**
- ⚠ **Properly!** To avoid personal injury, always follow manufacturers' instructions for safe operation of power tools.
- ⚠ **Ladder Safety!** Working at elevated levels can be hazardous. Always use ladders and scaffolding properly. Consult manufacturers' guidelines for safe use of these types of equipment.

Important

- Windsor reserves the right to change the information contained in these guidelines without notice.
- Maintain a minimum of 1/4" between the door frame and any trim, siding or masonry.
- Use of Windsor products in barrier EIFS systems (synthetic stucco) is not recommended. To do so will forfeit all warranties (written or implied). Windsor Windows & Doors will not be held responsible for any claims or damages resulting from water infiltration.
- Steel fasteners will corrode when used with ACQ pressure treated lumber. Use corrosion resistant fasteners (such as stainless steel) when installing doors in or around these types of materials.
- Doors must be properly flashed and sealed around the perimeter.

Handling and Storage

- Always carry door panels upright. Do not carry flat! Doing so could result in damage to the panels.
- Do not store units outside.

ATTENTION! ARBITRATION AGREEMENT; JURY TRIAL WAIVER; CLASS ACTION WAIVER. By purchasing, installing, or using this product, you agree to arbitrate any dispute you may have with Windsor relating to your Windsor products, and to waive your rights to a jury trial and to participate in class-action or class-arbitration proceedings, relating to any such disputes. For more details, and to learn how **YOU CAN OPT OUT OF THIS ARBITRATION AGREEMENT AND THESE WAIVERS**, please go to www.windsorwindows.com/support/Dispute Resolution.

Lead Paint and Existing Window or Door Disposal:

Before any remodel or renovation, make sure to identify any potential lead paint issues and take necessary steps to reduce the risk of lead contamination.

The U.S. Environmental Protection Agency (EPA) has issued a “Lead Renovation, Repair and Painting Rule (RRP)” for remodelers of older homes and buildings. This rule requires training and certification in lead-safe work practices for firms performing renovation, repair or painting on homes and child-occupied facilities built prior to 1978.

For more information regarding procedures for dealing with lead paint, please visit EPA’s website at www.epa.gov/lead.

When removing existing windows or doors, make sure to wear appropriate personal protective equipment. Extra precautions should be taken to protect others and property within the vicinity and below the removal window and surrounding components.

Consult with local waste authorities on the proper recycling or disposal of old window or door components.

Overview of Pinnacle Select Multi-Slide Doors

These sliding doors (also known as telescoping doors) are designed to be an economy system with superior weather performance for a wide array of projects that require a large opening multi-slider. These doors have multiple thermal design features, including specially designed gaskets and iso-bar technology, and are engineered to withstand any climate. Multi-Slide Door Systems are able to open an entryway as much as 100% when pocketing (storing) the doors. Fully customizable, our Multi-Slide Door Systems are state-of-the-art, high-quality, and easy-to-use.

The system is composed of several panels that slide and stack to one or both sides of an opening or are concealed entirely within a pocket.

RECOMMENDED TOOLS (NOT SUPPLIED):

- Carpenter’s Level (Optional: Laser Level)
- Wrench or Ratchet
- Rubber Mallet
- Tape Measures
- Caulking Gun and Sealant
- Self-Leveling Epoxy
- Power Drill

INCLUDED PARTS:

- Installation screws
- T-Handle (to tighten key corners)
- Channel Covers
- Key Corners (attached to header)
- Anchors (only for recessed tracks)
- Stopper (only for pocketing units)

Part 1: Preparing the Opening

1. Prior to checking the dimensions for the systems, ensure that the opening is square and plumb at the size stated on the paperwork.
2. Using a tape measure, check the height, width, and the dimension across the opening.

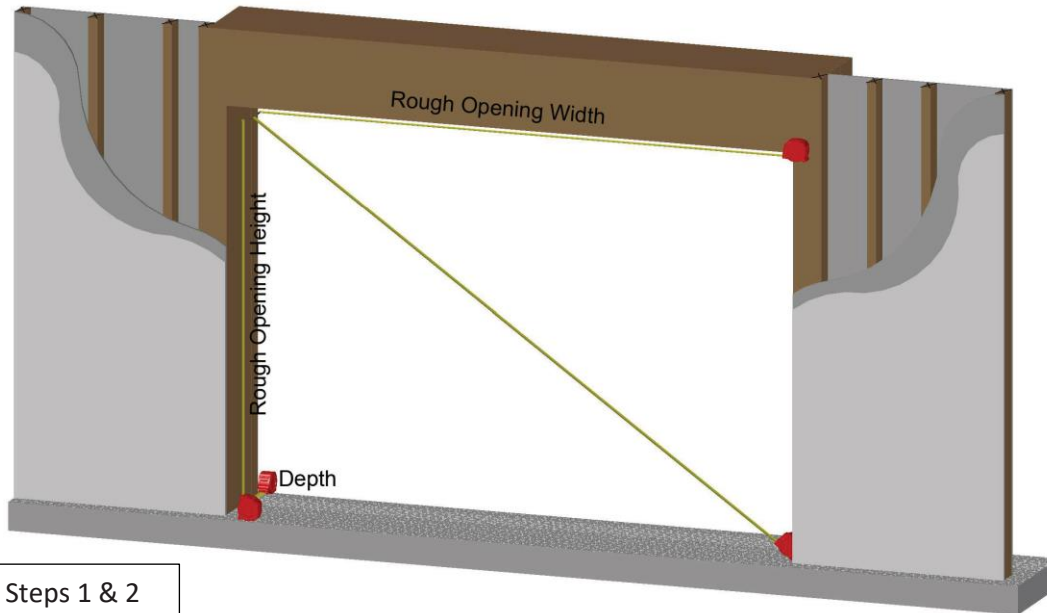

3. Place the head track and the side jambs into the opening, check to see that you have at least 1/2" shim space on both ends. **Shimming & leveling the system properly is important. Do not over or under shim.**

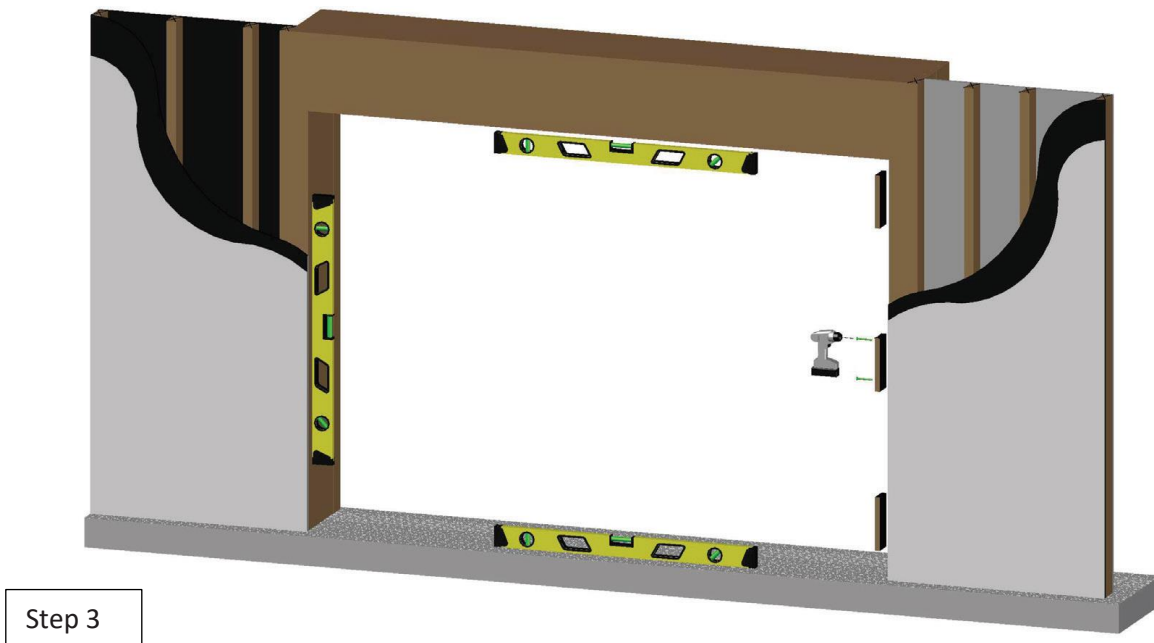

4. Once you are sure that the header and side jambs fit properly, it is time to prepare the opening. If the opening needs to be shimmed, apply shims, as necessary. There should still be at least 1/2" of clearance around the entire door. Check the entire opening to ensure that the opening is level and square. This is one of the most important steps and should **not be skipped**, to ensure proper operation of the door.

Part 2: Preparing the Bottom Track for Installation

The anchorage and leveling of the bottom track is important to ensure proper operation and longevity of the Sliding System(s) since they are weight driven and bottom loaded.

Please keep in mind that pilot holes are already pre-drilled in the headers, and side jambs. Verify that the rough opening and substrate for the track are level, clean, and free of debris (4" Installation screws will be provided with this system; other anchorage bolts will be at the customer's expense).

Part 3: Bottom Track Installation

FOR SURFACE MOUNTED TRACK:

1. Apply a bead of silicone on the side edges and on the interior edge of the bottom track. Secure the track using the screws provided and epoxy seal all screws.

FOR CORNER SURFACE MOUNTED TRACK:

1. Flip the bottom track upside down and apply silicone on all mitered edges and cavities.
2. Insert aluminum "L" brackets into track and screw both tracks together using #8 x 5/8" screws.
3. Carefully flip the track over, apply a bead of silicone on the side edges and on the interior edge of the bottom track. Secure track using the screws provided and epoxy seal all screws.



FOR RECESSED MOUNTED TRACK:

1. Install the bottom track in the trench and make sure the wheel guide will be exposed 3/16" after the finish floor is installed. Note the scoring on the wheel guide/track.

FOR CORNER RECESSED MOUNTED TRACK

1. Install bottom tracks in trench, remove screws from plate on the miter edge, apply silicone on all edges and screw both tracks together. Make sure the wheel guide will be exposed 3/16" after the finish floor is installed. Note the scoring on the wheel guide/track.



FOR ALL RECESSED TRACKS, USE THE LEVELING ANCHORS PROVIDED IN THE KIT:

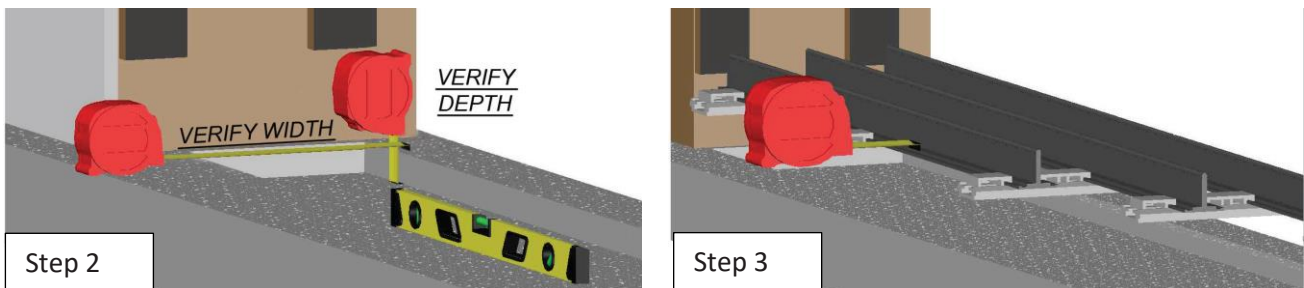

2. Double check the trench depth and width with the actual bottom track provided. The trench depth should have an extra 1/2" shim space provided below the track system setup. **Depth varies due to different track types.*
3. Insert Track into the trench to assure that the sizing is correct. Make sure the trench width is the same distance from the track on both ends.
4. Double check the track height to assure that a 3/16" lip can be achieved. The flooring needs to be installed in such a manner as to leave exactly 3/16" of the track exposed above the finished floor.

Part 4: Anchor Adjustments (For Recessed Tracks)

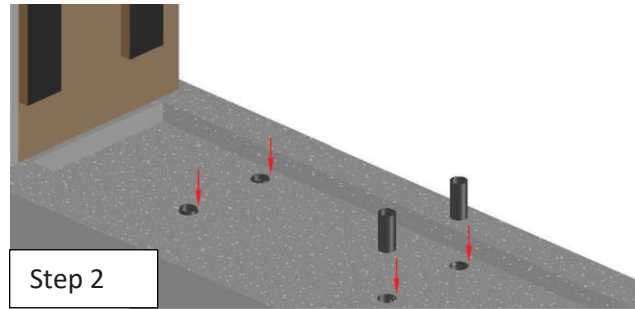
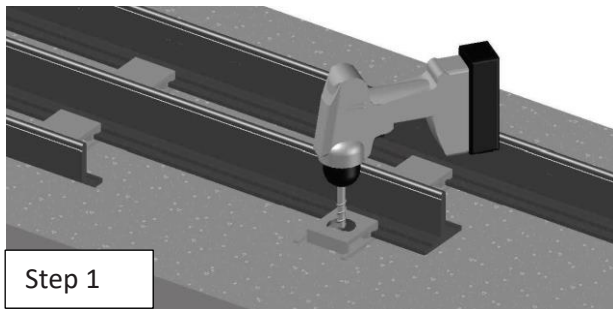

1. Use the track and the provided pilot holes in the “u-channel” as a guide to drill the holes for anchor bolts into the concrete trench. Holes must be 3/8” diameter and 1” deep.
2. Remove the track and drop the anchor receivers into the holes (1/4” x 20 drop-in anchors).
3. **Note:** *Once inserted, lock the anchors into the concrete by hammering the internal cone inside of the base of the anchor (use the settling tool provided with the anchors).*

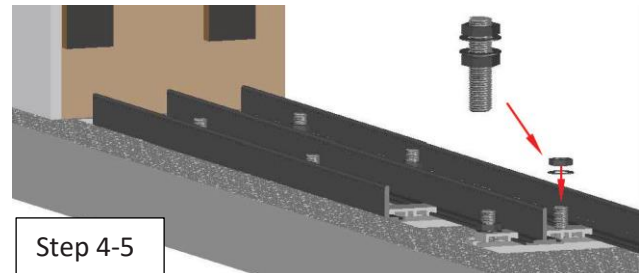
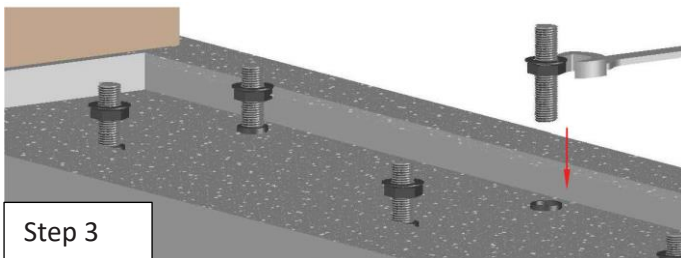

4. Insert the precut 1/4” threaded rod into the installed anchor receivers and then insert the nut and flat washer respectively. Adjust the height to achieve a 3/16” lip from the top of the finished floor.
5. Place the washer followed by the nut on top of the “u-channel”.
6. Adjust and tighten the nuts to anchor the track into place. Assure that the system is level as the track is being tightened down.

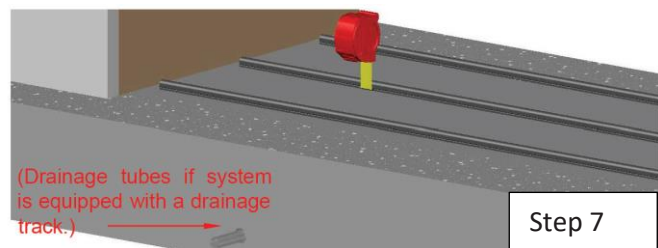
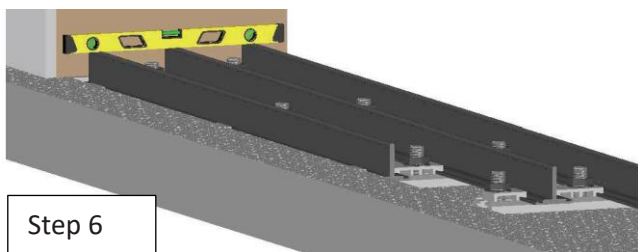

7. Once track is placed, leveled, and the anchor bolts have been secured into the proper place and height, use a level (laser level recommended) to assure the track is completely leveled.
8. When the track is at the correct height and the system has been completely tested with panels, fill all gaps between the tracks to the desired finish. Make sure 3/16” lips are exposed for systems wheels to glide smoothly along the system tracks.

Note: *Recessed track installation will vary depending on if you have the recessed or recessed with drainage version. Most recessed tracks will require shims to level the track. After leveling the track in the trench, back fill with high strength cement-based grout to ensure adequate support. Recessed tracks utilizing the “u-channel support” will be installed using the anchors provided. These anchors allow the track to be adjusted without the use of any shims. Back fill with concrete after leveling to ensure adequate support.*

Part 5: Frame Installation

Windsor Windows & Doors is not responsible for the support structure which the system will be attached to. Please ensure that the General Contractor waterproofs the area prior to installation.

Note: For the corner frame installation example, a set of wood support legs will be used to install the header and side jamb on each side of the corner unit. The installation method can vary depending on the configuration.

1. Loosen the corner keys on the header using the Allen Key provided.
2. Apply sealant on all edges and insert corner keys into the side jamb.
3. Tighten the corner keys and make that sure both miter cuts (45°) are tight.

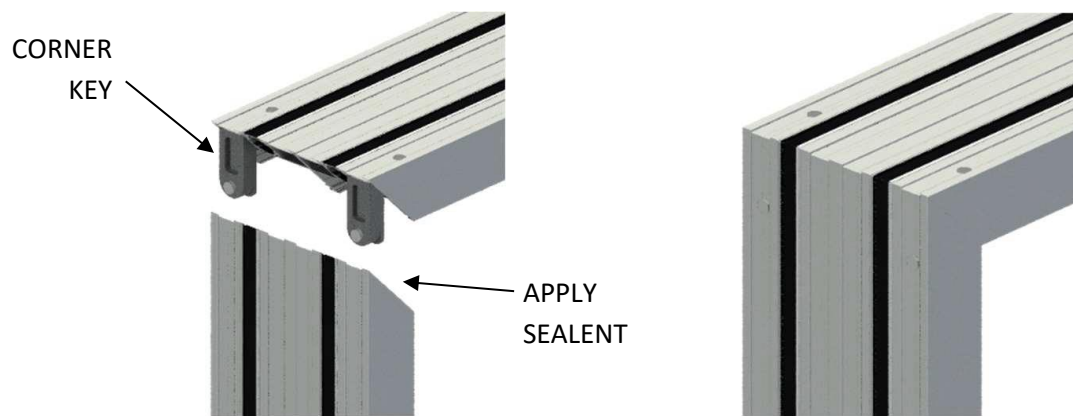

4. Once built, tilt and turn the frame into the opening.
5. Add sealant between the bottom track and the side jamb.
6. Make sure that each track guide is in the center of each side jamb channel. The adjustable keeper should be aligned with lead panel bottom track guide.

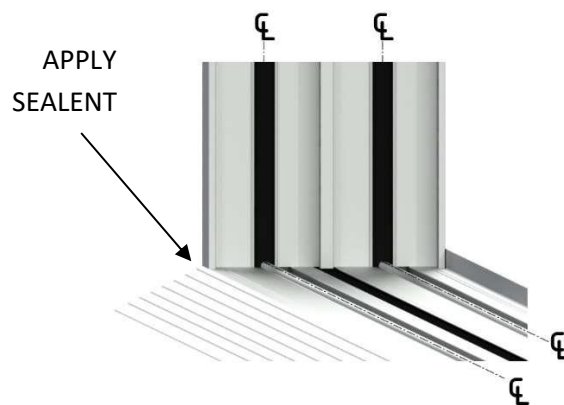

FOR CORNER DOOR FRAMES:

1. Temporarily secure the side jamb and the header in the opening.
2. Repeat steps 1 to 6 from above on the other side of the unit and insert aluminum "L" bracket into adjacent header.
3. Seal all mitered seams, aluminum cavities, and the header screw bracket.

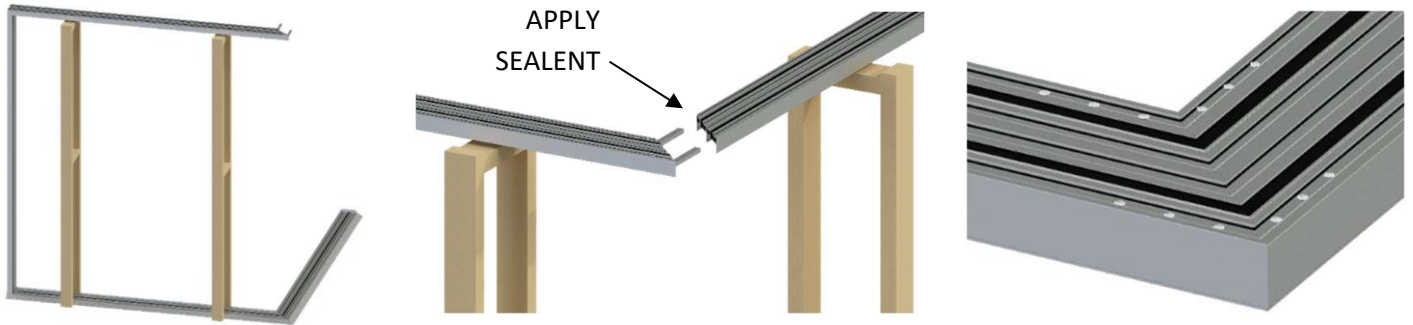

4. Once both head jambs are screwed together, ensure that the frames are square and plumb. Secure the frames using the 4" installation wood screws provided.
5. Remove wood support legs and verify that the unit height is the same all the way across the opening.

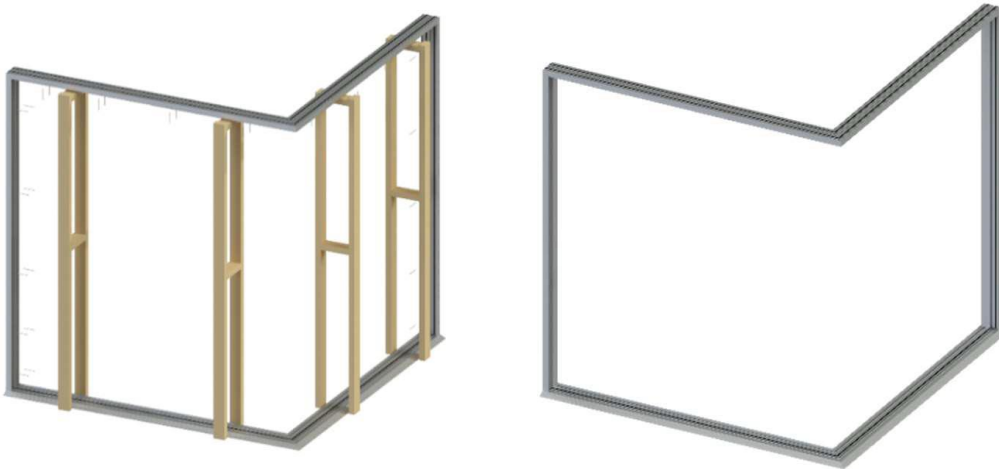

Part 6A: Panel Installation with No Pockets

Note: For Lift & Slide panels, retract the wheels (Locked Position) to ensure that they are protected during panel installation.

1. Install the panels into the frame, starting from the most interior panel. The exterior “fixed” panel will be the last panel installed. Insert and angle the top of the panel into the top frame channel and drop the panel on the center of each track guide. The use of suction cups to lift the panels is highly recommended. Be careful not to scratch the sill.

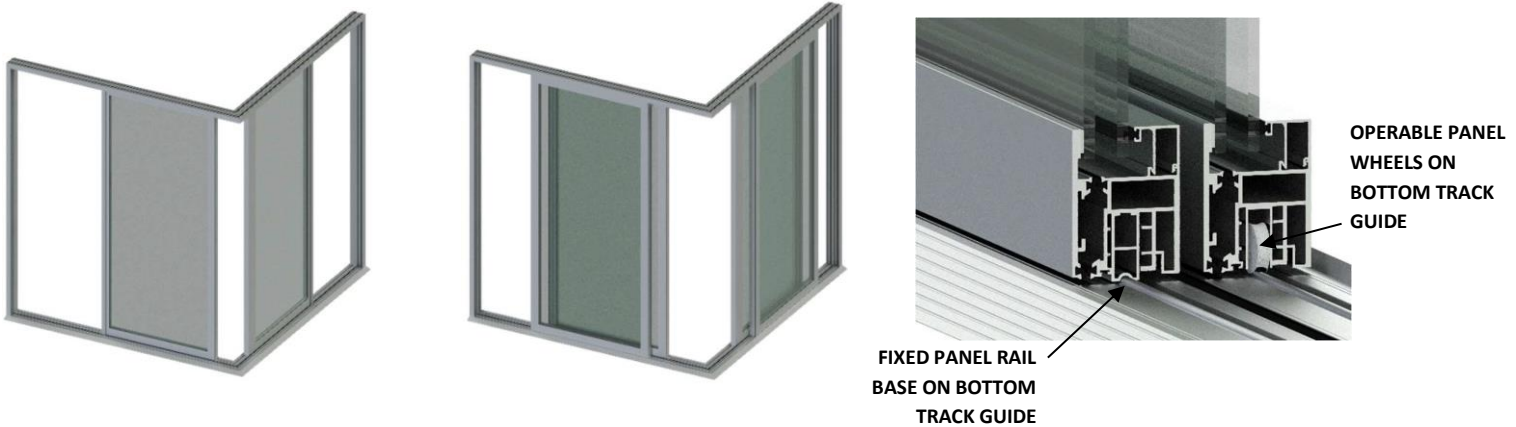

2. Push the “Fixed” panel back into the side jamb and check the operation of the unit. If necessary, evenly shim behind the “fixed panel rear block” to extend the group of sliding doors and reach the locking strike.
3. Check door operation and make any final adjustments.



4. Drill 1/8” pilot holes through the side jamb leg to the “Fixed panel rear block” and secure the fixed panel to the side jamb, using #8-3/4” long Phillips round head screw provided. These screws will be covered by the jamb covers in the next step.

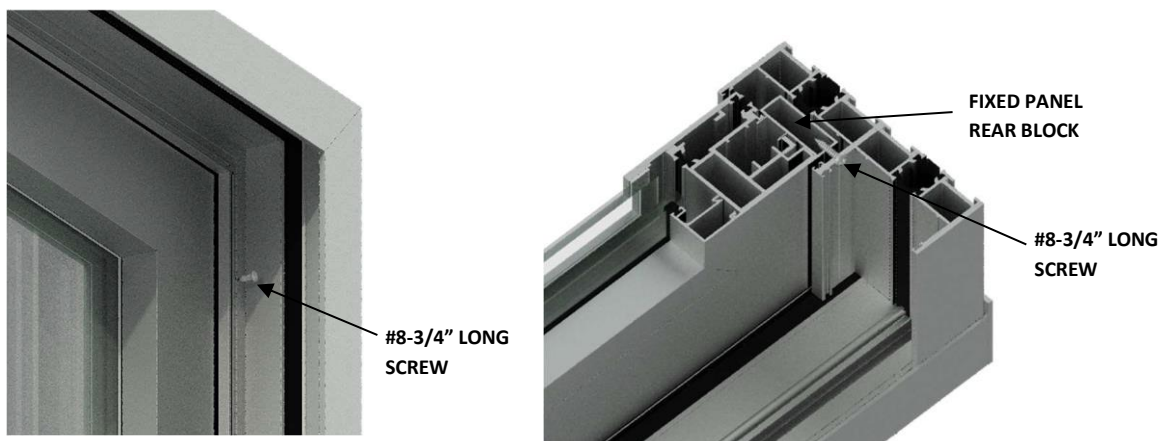

5. Install all side jamb covers first. Then install the head jamb covers. Pre-fit all covers to make sure no adjustments are needed before insertion.
6. Once the unit is completely installed, seal all joints and gaps around the frame.

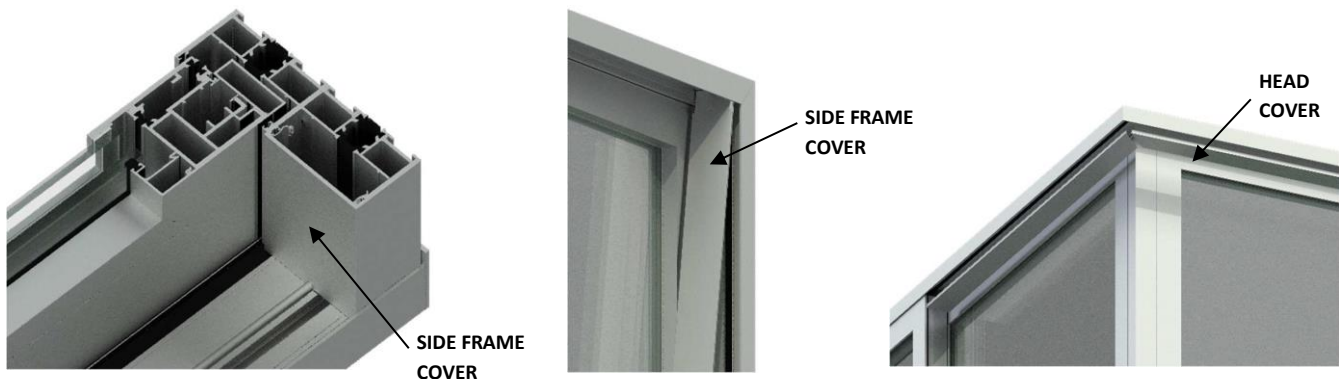

Part 6B: Panel Installation with Pockets

Note: For Lift & Slide panels, retract the wheels (Locked Position) to ensure that they are protected during panel installation.

Every system comes from the factory already tested to ensure proper operation of each panel and wheel mechanism. When installing the panel, make sure that the panels are inserted to where the panel interlocks will be on the proper sides of each other. If the panels are inserted incorrectly, the door will not operate properly, and it may cause damage to the system.

1. Install frames following installation steps on Part 5.
2. Install the panels into the frame, starting from the most interior panel. Insert and angle the top of the panel into the top frame channel and drop the panel on the center of each track guide. The use of suction cups to lift the panels is highly recommended. Be careful not to scratch the sill.
3. Insert the following panel and make sure that the interlocks overlap.
4. Lock the lead panel and push the last panel back simulating the unit being closed at the lock position.



5. Insert the “pocket interlock” extrusion between the unit and the wall. This will interlock with the last panel. Shim or adjust the pocket wall for proper installation and anchor the pocket interlock to the wall.

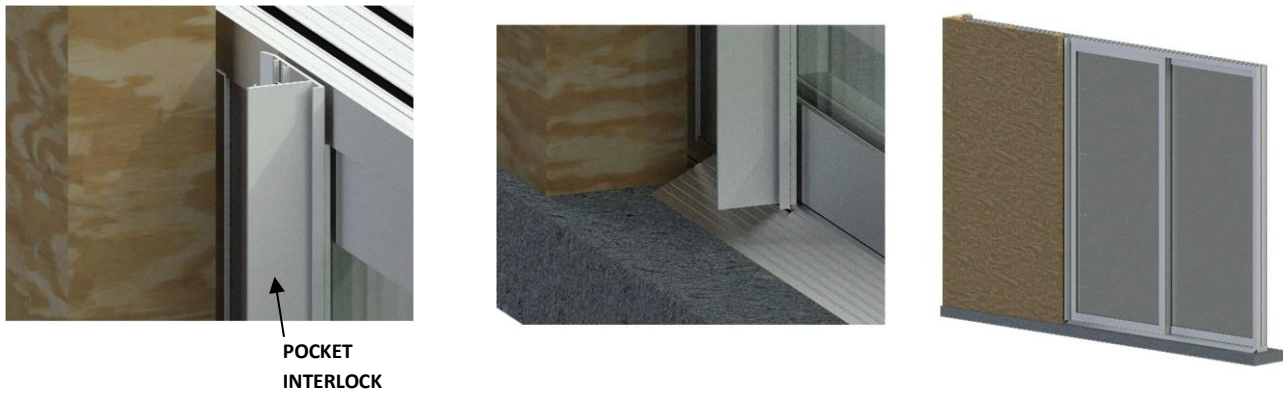

6. Once the unit has been installed and has been checked and no other adjustments are needed, proceed by installing the jamb covers.
7. To continue installation, the interior pocket frame needs to be constructed.
8. Install the pocket wood pocket cover on the “triangular” blocks, located on the back edge of the last panel.
Note: Two panel systems will have an “L” shaped aluminum angle instead of the “triangular” blocks. The side with the weatherstrip goes toward the interior wall.
- a. Installation method may vary depending on the material of the pocket cover.
(screws are not provided for the pocket cover and will have to be sourced by the installer according to the finish material)



9. If you have a bi-parting door, there will be no side jambs. Instead, there will be 2 pocket interlock extrusions for each side of the opening. Follow the steps as if one pocket is installed.

Part 7: Completion and Adjustment

1. Panel Adjustment:
 - a. The lower corners of each operable panel can be adjusted up or down by removing the adjustment screw covers and using a 5 mm Allen key to adjust up (clockwise) or down (counterclockwise). *It is recommended to use a prybar to relieve some of the panel weight before adjusting.*
 - b. Adjust rollers independently until the sides of the panels are parallel with the side jamb and the adjacent panels.
2. Keeper Adjustment:
 - a. Adjust the lock keepers until the door locks easily.
 - b. They can be adjusted up or down and side-to-side.
3. Operate the door to ensure proper operation. The panels will not operate correctly if the door is out of square, over-shimmed or over-insulated.
4. Completely seal around exterior perimeter between door frame and the rough opening or wall exterior.
5. Remove all labels and shipping materials.
6. Properly finish all wood/cellular PVC interior and exterior components within 60 days of installation. See the Care and Use Guide, located at www.windsorwindows.com for further details on finishing Pinnacle multi-slide doors.
7. **IMPORTANT:** Do not stain or paint any hardware or vinyl components.
8. Apply the handle set as per the manufacturers' recommendations. Complete final adjustments, as necessary.
9. Sliding doors are to remain closed and locked during construction to prevent site conditions from damaging and/or warping panels and frames. Allow 10-12 weeks from project completion for the building temperature and humidity levels to stabilize and door panels to acclimate.

Part 8: System Finishing

Once all the steps are completed and the door is installed, it is time to properly seal the system. We recommend that all finished work be completed by a General Contractor to fully seal and close the openings.

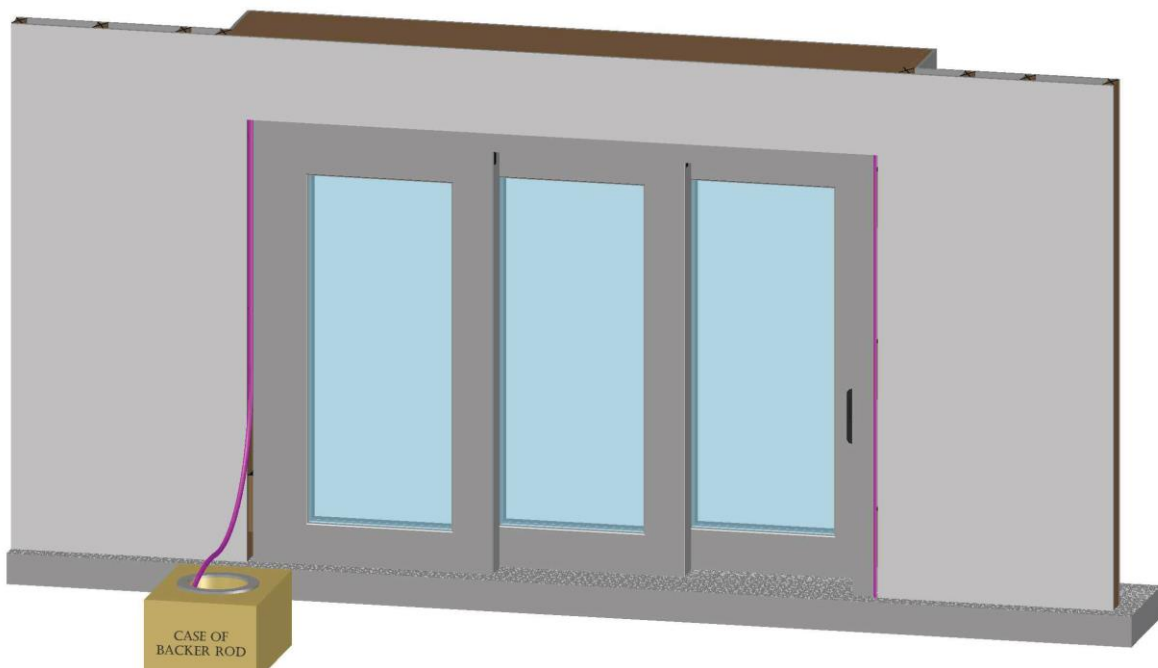

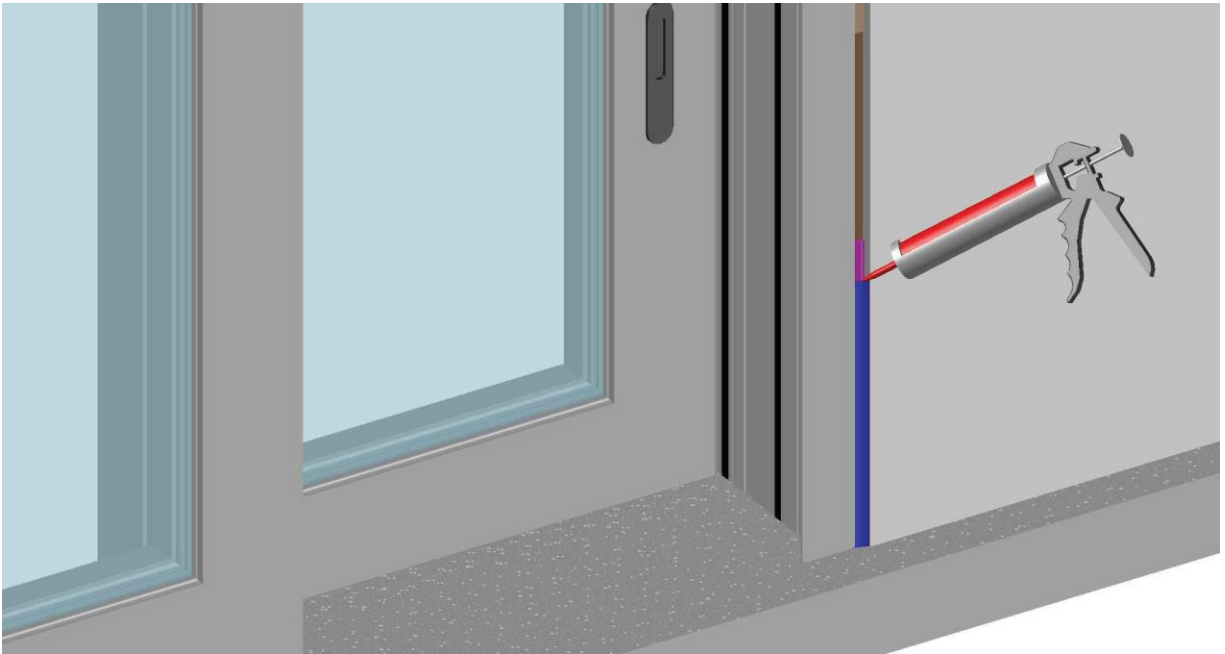

If you have any questions regarding your Windsor Windows, please contact Windsor Windows & Doors directly at 1-800-218-6186. Or you can visit us online at www.windsorwindows.com, where you will find helpful information as well as our Care and Use Guides, which will assist you in preserving your windows and patio doors. While you are at our site, you can also complete and submit the form on the Contact page, and one of our window specialists will promptly answer your question.

Care and Use

For information about the care and use of your Windsor products, please visit the www.windsorwindows.com/support, and click “Warranty, Care, & Installation,” where you find a link to our Care and Use Guide. Or contact your local independent Windsor distributor and ask for a copy of the Care and Use Guide, which contains information on finishing, cleaning,

what to look for during yearly inspections, general maintenance tips, sash/panel adjustment, sash/panel removal, screen removal and information on condensation. You should inspect your windows or doors annually.

Warranties

You can find a copy of our current Warranty at the website, under the “Support” tab. If you have Windsor products that are older, please contact Windsor at 1-800-218-6186, and we will provide a copy of the applicable warranty.