

# Rigid Drip Cap and Rigid Nail Fin Option



**WINDSOR**  
WINDOWS & DOORS  
A WOODGRAIN MILLWORK COMPANY

## Cut Nail Fin & Drip Cap Parts

- Rigid Drip Cap Length = Frame Width
- Side Nail Fin Length = Frame Height – 1/4"
- Sill Nail Fin = Frame Width – 1/2"

## Silicone Application

Apply 3/16" bead of silicone along the nail fin groove on all four sides of the unit, Figure 1.

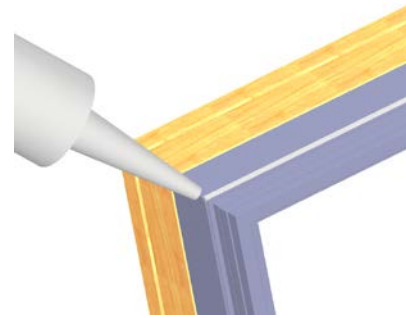

Figure 1

## Attach Drip Cap

Apply the drip cap and fasten to the clad using #8 x 1/2" truss head self-tapping screws (PN 8019). Screws should be 1" from both ends and 8-10" on center, Figure 2.

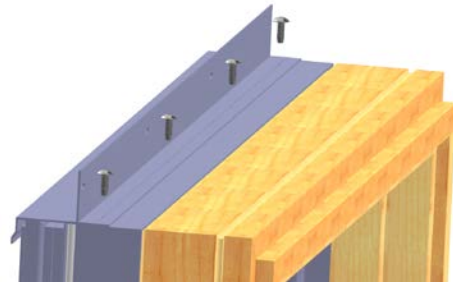

Figure 2

## Attach Side & Sill Nail Fins

Apply the side nail fins to the clad using the #8 x 1/2" truss head self-tapping screws (PN 8019). Screws should be 1" from both ends and 8-10" on center, Figure 3.



Figure 3

## Apply Corner Gaskets

Remove gaskets from liner, attach to corner, and fold over as shown in Figure 4. Repeat on all four corners.

Apply silicone to the back side of the gaskets to fill in the pin hole left in the corner, Figure 5.

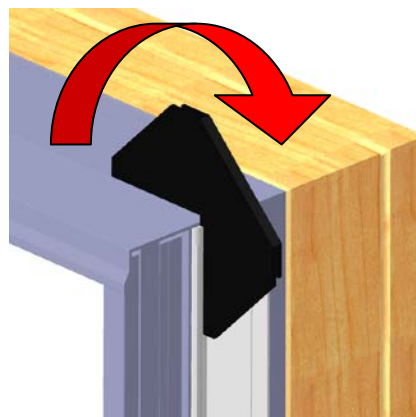

Figure 4



Figure 5