

04

ZIP System - Window Installation

DISCLAIMER: The following steps represent a general overview for the proper installation of window flashing. Please defer to/consult the installation instructions of your window manufacturer as well as code requirements in your jurisdiction for full installation details.

Flanged Windows

1. Fasten the ZIP System wall sheathing sheathing to the wood frame and install ZIP System tape to all wall panel seams, as de-tailed in sections 02 and 03.

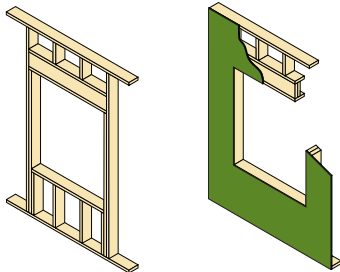

5. Cut a length of ZIP System tape or another adhesive-backed flashing tape (must meet ICC-ES Acceptance Criteria for Flashing Materials (AC148)) and apply to the header, ensuring that the flashing overlaps the jamb flashings.*

Once the tape is in place, use the tape gun or roller to seal the flashing to the sheathing.

*DO NOT tape bottom flange.

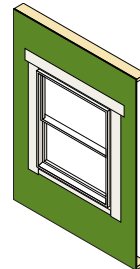

2. ZIP System tape may be used as pan flashing if installed in accordance with flanged window installation details posted on zipsystem.com. Other adhesive-based flashing tapes (must meet ICC-ES Acceptance Criteria for Flashing Materials (AC148)) may be used as pan flashing if installed per ASTM 2112-07. Apply the flashing to cover the bottom of the opening, overhanging onto the sheathing by at least 2" and extending a minimum of 6" up each jamb.

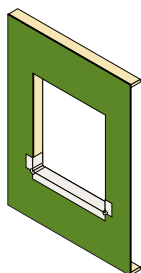

6. From the interior, apply low-pressure polyurethane foam (for windows) between the rough opening and the window frame. (Caulk sealant compatible with the sill flashing may be used at the sill if the opening between the sill flashing and window is too narrow to allow the use of low-pressure polyurethane foam.)

When using ZIP System tape, butyl, silicone or polyurethane sealants are acceptable. Do not use latex sealants with ZIP System tape. If using another flashing tape, follow the flashing manufacturer's recommendation in selecting a sealant compatible with that flashing.

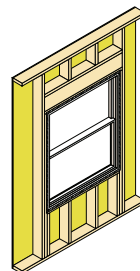

3. Apply sealant around inside face of mounting flange. Sealant must be gapped at the sill to permit drainage. Install and level window per manufacturer's installation instructions. Verify sealant compatibility with window manufacturer. When using ZIP System tape as pan flashing, butyl, silicone or polyurethane sealants are acceptable. Do not use latex sealants.

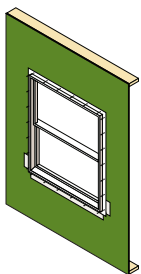

4. Cut two pieces of ZIP System tape or another adhesive-backed flashing tape (must meet ICC-ES Acceptance Criteria for Flashing Materials (AC148)) and apply to each of the window jamb flanges, ensuring the jamb flashings overlap the sill flashing.

Once the tape is in place, use the tape gun or roller to seal the flashing to the sheathing.

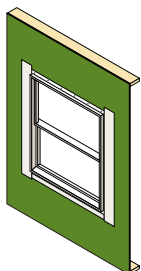

Brick Mould Windows

1. Fasten the ZIP System wall sheathing sheathing to the wood frame and install ZIP System tape to all wall panel seams, as de-tailed in sections 02 and 03.

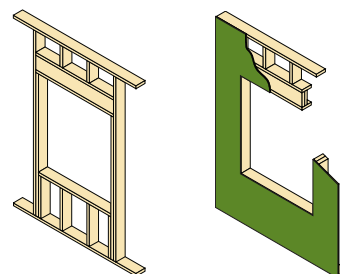

2. If recommended by the window manufacturer, cut a strip of wood to function as a back dam at the sill. The wood strip should have a length equal to the width of the rough opening and a height and width of at least 1/2". Position the block at the inside edge of the window frame.

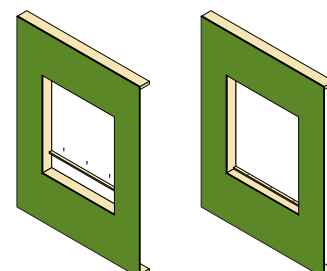

ZIP System - Window Installation

DISCLAIMER: The following steps represent a general overview for the proper installation of window flashing. Please defer to/consult the installation instructions of your window manufacturer as well as code requirements in your jurisdiction for full installation details.

Brick Mould Windows (continued)

3. ZIP System tape may be used as pan flashing if installed in accordance with brick mould window installation details posted on zipsystem.com. Other adhesive-based flashing tapes (must meet ICC-ES Acceptance Criteria for Flashing Materials (AC148)) may be used as pan flashing if installed per ASTM 2112-07. Apply the flashing to cover the bottom of the opening, overhanging onto the sheathing by at least 2" and extending a minimum of 6" up each jamb.

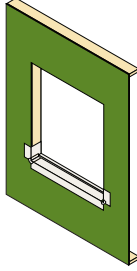

7. Cut a piece of rigid head flashing so that when installed, it is flush with the edges of the exterior moulding of the window. Apply a bead of sealant to the back and bottom surface of the rigid head flashing. Use sealant recommended by the flashing manufacturer.

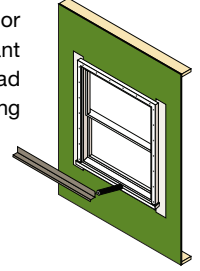

8. Secure the rigid head flashing to ZIP System wall sheathing.

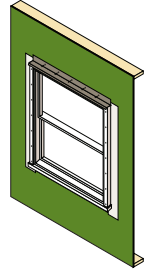

4. For vertical jambs, cut ZIP System tape or another adhesive-backed flashing tape (must meet ICC-ES Acceptance Criteria for Flashing Materials (AC148)) and apply to each of the window jambs. Ensure that they cover the entire inside of the rough opening as well as overlap onto the sheathing by at least 2". Flashing shall also extend above the rough opening, such that it will project 1" beyond the exterior trim of the window.

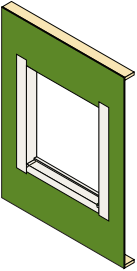

Once the tape is in place, use the tape gun or roller to seal the flashing to the sheathing.

9. Cut a length of ZIP System tape or another adhesive-backed flashing tape (must meet ICC-ES Acceptance Criteria for Flashing Materials (AC148)) and apply to the rigid head flashing, ensuring that the adhesive-backed flashing overlaps the jamb flashings.

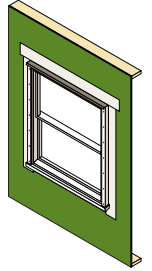

Once the tape is in place, use the tape gun or roller to seal the flashing to the sheathing.

5. Apply sealant to jambs and header allowing for drainage at the sill in accordance with window manufacturer's installation instructions. When using ZIP System tape, use a butyl, polyurethane or silicone sealant. Do not use latex sealants with ZIP System tape. When using another flashing tape, follow the flashing manufacturer's recommendations in selecting a sealant compatible with that flashing.

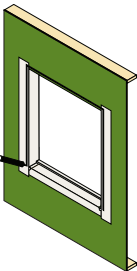

10. From the interior, apply low-pressure polyurethane foam (for windows) between the rough opening and the window frame. (Caulk sealant compatible with the sill flashing may be used at the sill if the opening between the sill flashing and window is too narrow to allow the use of low-pressure polyurethane foam.)

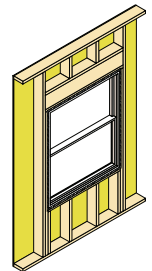

When using ZIP System tape, butyl, silicone or polyurethane sealants are acceptable. Do not use latex sealants with ZIP System tape. If using another flashing tape, follow the flashing manufacturer's recommendation in selecting a sealant compatible with that flashing.

6. Install and level window per manufacturer's installation instructions.

